

# Tefal®

EN

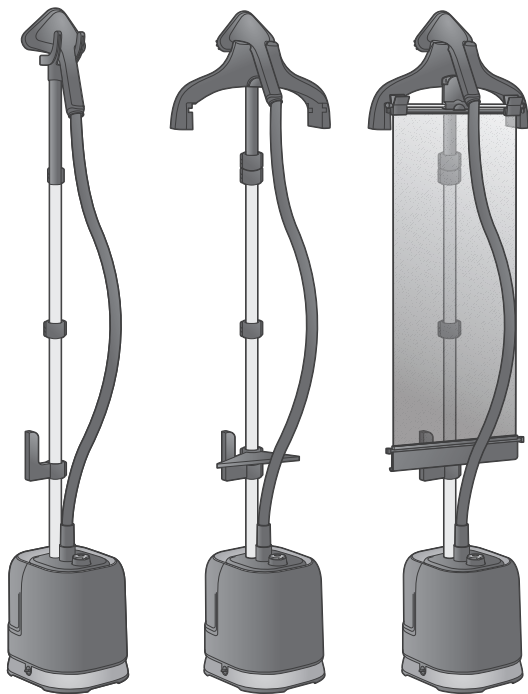

IT34XX

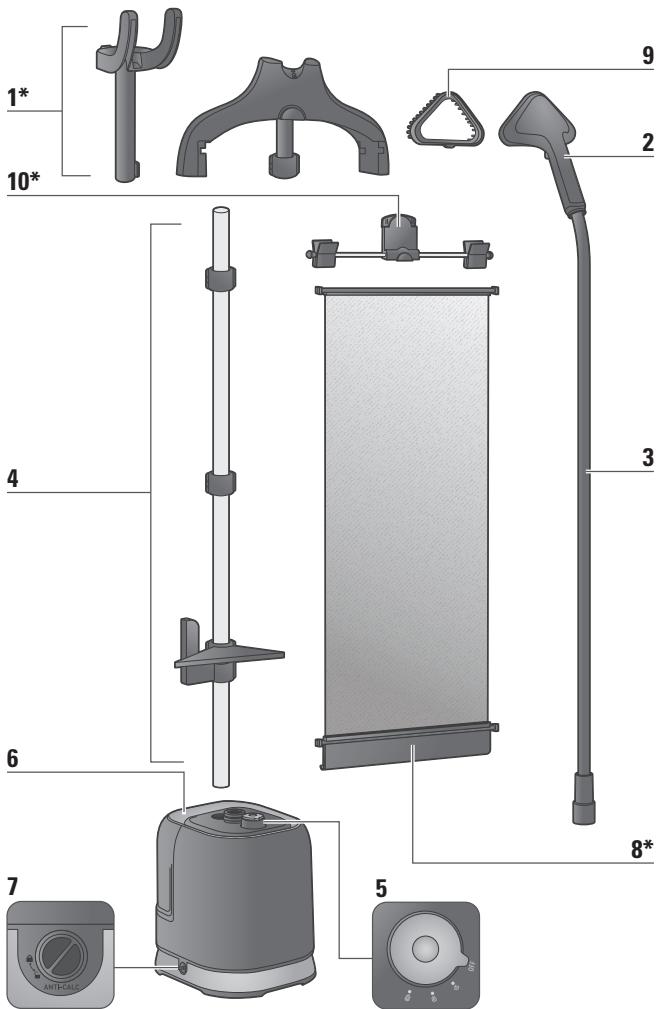

\* Depending on model

# SAFETY INSTRUCTIONS

**Please read these instructions carefully before first use and keep them in a safe place.**

- Never leave the appliance unattended whilst connected to the power supply, even if for a few moments, especially where children are present.
- Always unplug your appliance: before filling, or rinsing the water tank, before cleaning it, after each use.
- Care should be taken when using the appliance due to the emission of steam.
- This appliance is not intended to be used by persons (including children) with reduced or impaired physical, sensory or mental capabilities or persons lacking appropriate knowledge or experience, unless a person responsible for their safety provides either supervision or appropriate instructions concerning use of the appliance prior to its use.
- This appliance can be used by children aged from 8 years and above and persons with reduced physical, sensory or mental capabilities or lack of experience and knowledge if they have been given supervision or instruction concerning use of the appliance in a safe way and understand the hazards involved.
- Children must be supervised to ensure that they do not play with the appliance.
- Cleaning and user maintenance shall not be made by children without supervision.
- The appliance must not be used if it has fallen to the floor, shows evidence of damage, leaks or fails to function correctly. Never dismantle your appliance. To avoid any danger, have it inspected in an approved service centre.

## IMPORTANT RECOMMENDATIONS

- This product has been designed for domestic and indoor use only. Any commercial use, inappropriate use or failure to comply with the instructions, the manufacturer accepts no responsibility and the guarantee will not apply.
- This is a floor appliance, never carry it while in use.
- This appliance is designed to function on AC current only. Before using it for the first time, check that your mains supply voltage matches that indicated on the appliance data plate.
- Any connection error will invalidate your guarantee.
- Always plug the appliance into a socket outlet with an earth connection.
- Given the diverse standards in effect, if the appliance is used in a country other than that in which it is purchased, have it checked by an Approved Service Centre.
- Always keep the hose and nozzle elevated above the water tank.
- For your safety, this appliance conforms to the applicable standards and regulations (Low Voltage, Electromagnetic Compatibility, and Environmental Directives).
-  The surfaces which are marked or close to with this sign are very hot during the use of the appliance. Do not touch these surfaces before the appliance has cooled down.
- To reduce the risk of contact with hot water or steam emitting from steam vents, check the appliance before each use by holding it away from your body and operating.
- Steam only in an up and down vertical motion. Never use the steam head in a horizontal position or tilt into a backward position, this may result in hot water discharge.
- To reduce the risk of electric shock, do not immerse the appliance or the steam head in water or any other liquids.
- The appliance should always be switched «OFF» before plugging or unplugging from socket outlet. Never pull the cord to disconnect it from the socket outlet, instead grasp the plug and pull to disconnect.
- Do not allow the cord to touch hot surfaces. After each use, unplug and let the appliance cool down completely before storing it away. Loop the cord loosely around the appliance when storing.
- Never place the appliance or its power cord near, or allow to come into contact with, sources of heat or sharp edges.
- “Before plugging your appliance, please ensure the full insert and locking of steam hose (by soft vertical pulling). During use, never unlock and never remove the steam hose as hot water and steam projection can occur.
- Do not attempt to hang up the unit using the hose.
- The use of accessory attachments other than those provided by Tefal is not recommended and may result in fire, electric shock or personal injury.
- Use caution when changing accessories or attachments, as they may contain



hot water from condensation. Ensure that the attachments have cooled down to avoid contact with hot water.

- Burns could occur from touching hot parts, hot water or steam. Use care when you empty a steam appliance. There may be hot water in the tank or from the inside the appliance.
- Do not direct steam at people, animals or steam clothes while they are being worn.
- Do not cut or attempt to extend the steam hose.
- Do not use an extension lead. If you accept liability for doing so, only use an extension lead which is in good condition, has a plug with an earth connection and is suited to the power rating of the appliance.
- Unwind the power cord fully before use and inspect the appliance and power cord for signs of wear or damage prior to connecting to the power supply.
- Any intervention other than normal cleaning and maintenance by the customer must be performed by an Approved Service Centre.
- Never drop or insert any object into any opening or hose.
- The glove should be only used with this garment steamer (\*depending on model). The manufacturer accepts no responsibility for any inappropriate use.
- Remove all packaging materials, stickers and accessories from inside and outside of the appliance.
- Inspect the appliance and power cord for signs of wear or damage prior to connecting to the power supply.
- Do not use your appliance if it does not operate correctly, if it has been damaged or if the power cord or plug is damaged. To maintain safety, these parts must be replaced by an Approved Service Centre.
- Any intervention other than normal cleaning and maintenance by the customer must be performed by an Approved Service Centre.
- This unit is for indoor use only.
- Unwind the power cord fully before use and inspect the appliance and power cord for signs of wear or damage prior to connecting to the power supply.
- The glove should only be used with this garment steamer, and not for other purposes.

## ENVIRONMENT PROTECTION FIRST!



- ① Your appliance contains valuable materials which can be recovered or recycled.
- ➡ Leave it at a local civic waste collection point.

# SAVE THESE INSTRUCTIONS

## TROUBLESHOOTING

Problems	Possible causes	Solutions
There is no steam.	The appliance has not been switched on.	Check that the appliance has been plugged in correctly. Press the On/Off button. The appliance will begin producing steam after approximately 60 seconds.
	The hose has been obstructed.	Check that the hose is not bent or twisted. Check that the steam head is not laying down on the floor.
	There is no water left in the water tank.	Switch off the appliance and fill the water tank.
The steam flow is low.	Your steamer has a build-up of scale because it has not been rinsed out regularly or descaled.	Follow the «easy descaling» process.
	The hose has been obstructed.	Check that the hose is not bent or twisted.
Water runs through the holes of the steam head.	There is condensation in the hose.	Never use the steamer in the horizontal position. Hold the hose vertically outstretched and wait for the condensed water to return to the steamer.
The steamer takes a long time to heat and/or ejects white particles.	Your steamer has a build-up of scale because it has not been descaled regularly.	Follow the «easy descaling» process
The Press & Steam accessory is crooked.	The Press & Steam accessory has not been assembled properly.	Reassemble the Press & Steam accessory inside the integrated hanger. Make sure it is properly hooked in place by following the instructions.
	The Press & Steam accessory has not been rolled properly.	Make sure the Press & Steam accessory is always dry then rolled with care when stored. Do not crease it for storage.
The Press & Steam accessory detaches while in use.	The Press & Steam accessory was not locked correctly in the hook.	Make sure the Press & Steam accessory handle is firmly locked in the hook. It should not be moving horizontally or vertically. Make sure the 4 segments of the pole are fully extended and that the 3 clips are firmly locked.

The hose makes a gurgling noise.	You are using the steam head in a position close to the ground and some condensation occurs in the hose.	Raise the hose frequently during use and adjust the pole to its maximum height in order to avoid the formation of condensation.
Water is overflowing from water tank.	You are using the steam head in a position close to the ground and some condensation occurs in the hose.	Raise the hose frequently during use and adjust the pole to its maximum height in order to avoid the formation of condensation.

If you have any further problems or queries please contact the Customer Relations Helpline - see details at the end of this leaflet.

# PRODUCT DESCRIPTION

---

1. Hanger\*
2. Steam Head
3. Steam Hose
4. Adjustable poles
5. ON / OFF Button
6. Removable Water tank
7. Draining Cap
8. Vertical Support\*
9. Fabric Brush
10. Hanger & clips\*

\* Depending on model

## 1. ASSEMBLY

---



EN

Insert the pole in the housing until you hear a "click".

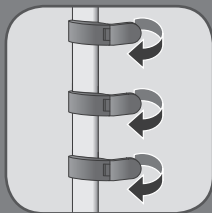

EN

Open the three pole locks.

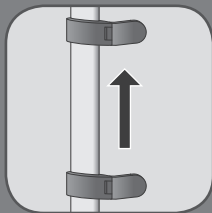

EN

Extend the pole fully.



EN

Close the three locks.



**EN**

Fully insert the hanger vertically on top of the pole and lock it.



**EN**

Position the steam head on its cradle.



**EN**

Insert the steam hose , and lock it, by screwing until hearing a "click".

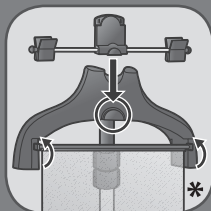

**EN**

Add the vertical support and the hanger.

\* Depending on model

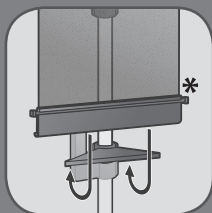

**EN**

Unwind the support and fix it, by adjusting the tension with the dedicated hook and lock it.

## 2. BEFORE USE



**EN**

Remove the water tank.



**EN**

Remove the cap then fill in the water tank.

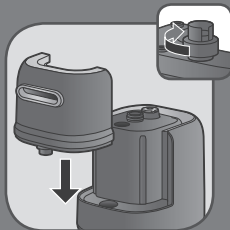

**EN**

Fully screw the water tank cap and insert tank back in appliance.

\* Depending on model



EN

Add the clothe of your choice on the hanger.

### 3. ACCESSORIES

---



EN

Accessories must be settled when appliance is cold and not running.



EN

The fabric brush opens the weaves of the fabrics for better steam penetration.



## 4. USE

---



EN

The appliance must remain in a horizontal position on the floor.

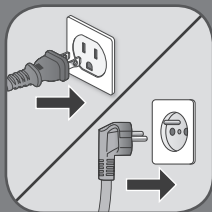

EN

Plug in the appliance.

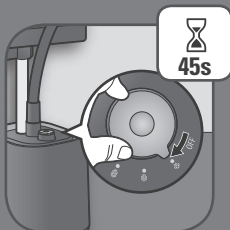

EN

Turn the On/Off Button, in order to switch on the appliance. Then, adjust steam output by turning the button.



EN

After 45 seconds approximately, steam will come out.

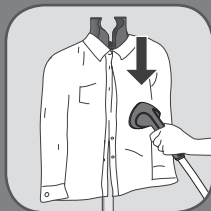

**EN**

For optimal use, pass the steam jets on your garment from top to bottom.



**EN**

Never steam directly on people.

## 5. DURING USE

---



**EN**

If steam is not coming out anymore, this can be due to low water level in tank.



**EN**

Turn the on/off button to the "OFF" positioning, in order to switch off the appliance.



**EN**

Unplug, then remove the water tank.



**EN**

Remove the cap then fill in the water tank.

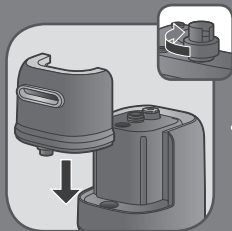

**EN**

Fully screw the water tank cap and insert tank back in appliance.

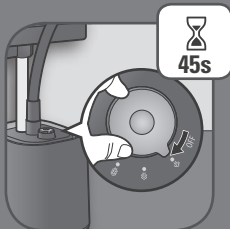

EN

Turn the On/Off Button, in order to switch on the appliance. Then, adjust steam output by turning the button.

## 6. AFTER USE

---



EN

Turn the on/off button to the "OFF" positioning, in order to switch off the appliance.

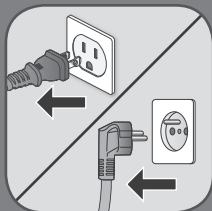

EN

Unplug the appliance.



EN

Remove the water tank.



EN

Unscrew the cap and then empty the water tank completely in a sink.

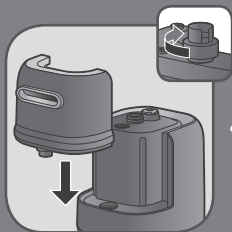

EN

Screw back the cap and place the water tank back to its appliance.

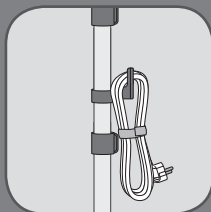

EN

Roll up the power cord and place it on its hook.



EN

Wait for an hour for your appliance to cool before storing.

## 7. DESCALING PROCEDURE



EN

To apply every 6 months or in case of performance decrease.



1h

EN

WARNING! Wait for an hour that appliance completely cools down.

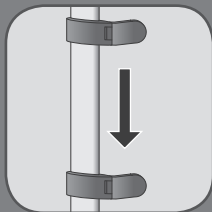

EN

Remove the steam head from the cradle, unlock & collapse the pole.



EN

Remove the water tank.



EN

Fill in 0.5L(litre) of water in the appliance tank inlet.



EN

Shake Gently the appliance to remove the main particles.



EN

Place the appliance over a sink & unscrew the «Anti calc» cap by turning it anti clockwise.



EN

Be careful , water might be hot.



**EN**

Vertically tilt the appliance to empty mix in a sink.

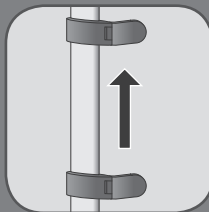

**EN**

Unlock the pole , uncollapse, lock.



**EN**

Position the steam head on its cradle.



**EN**

Remove the cap then fill in the water tank.



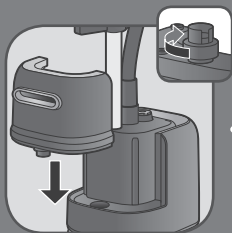

**EN**

Fully screw the water tank cap and insert tank back in appliance.

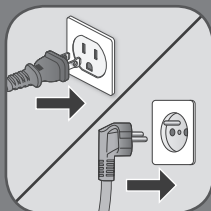

**EN**

Plug in the appliance.



**EN**

Let the appliance run until water tank is emptied completely.

## 8. CLEANING



EN

Wait an hour for complete cool down.



EN

Only use a sponge with water to clean the base.



EN

Only use a sponge with water to clean the steam head.



EN

Never use detergents when cleaning your appliance.



**EN**

Never wash or rinse appliance directly over a sink.



**EN**

Never wash or rinse the steam head directly over a sink.

